

# Multi-Family Capabilities



# FROM THE GROUND FLOOR... TO THE PENTHOUSE.



Choice Cabinet is a leading manufacturer of multi-family cabinetry for properties of all sizes. With decades of experience, you can count on our quality and craftsmanship. We have the styles you and your residents want, the prices to help you stay within your budget, and much more.

**The Choice Cabinet Multi-Unit Properties program offers the following solutions:**

- Fully custom product for any 350+ cabinet quantity orders
- Paint, stain, acrylic, laminate, PETG & TFL finishes in framed and frameless construction
- KCMA Certified, CARB2 Compliant & ANSI Standard A161.1-2012
- Kitchen & bath ADA, HUD, Severe Use and other use cabinetry available
- Detailed bids, production samples, long term support & warranty services

We look forward to hearing about your project, and we're eager to help you meet your goals. When price, speed and quality are what matters most, Choice Cabinet is the only name you need to know.





# CONSTRUCTION OPTIONS

## FRAMED PARTIAL OVERLAY



### CONSTRUCTION METHOD: Pocket Screw

1. 1/2" plywood end panels with exterior finished to match
2. 3/4" solid Maple face frame
3. 3/4" solid wood corner braces
4. 5/8" veneered plywood dovetailed drawer box  
+ Option: 5/8" solid wood dovetailed drawer box
5. Self closing undermount epoxy coated 75 lb. glides  
+ Option: Self closing undermount epoxy coated 75 lb. glides  
+ Option: Soft close full extension undermount 100 lb. glides
6. 6-way adjustable concealed hinges  
+ Option: Soft close 6-way adjustable concealed hinges
7. 5/8" veneered plywood half depth adjustable shelving  
+ Option: 5/8" veneered plywood full depth adjustable shelving
8. Natural finish interior

### Certifications



1" Reveal

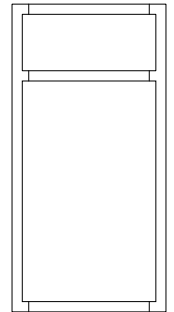

## FRAMED FULL OVERLAY



### CONSTRUCTION METHOD: Pocket Screw

1. 1/2" plywood end panels with exterior finished to match
2. 3/4" solid Maple face frame
3. 3/4" solid wood corner braces
4. 5/8" veneered plywood dovetailed drawer box  
+ Option: 5/8" solid wood dovetailed drawer box
5. Full extension side-mount ball bearing 100 lb. drawer glides  
+ Option: Self closing undermount epoxy coated 75 lb. glides  
+ Option: Soft close full extension undermount 100 lb. glides
6. 6-way adjustable concealed hinges  
+ Option: Soft close 6-way adjustable concealed hinges
7. 5/8" veneered plywood half depth adjustable shelving  
+ Option: 5/8" veneered plywood full depth adjustable shelving
8. Natural finish interior

### Certifications



1/4" Reveal

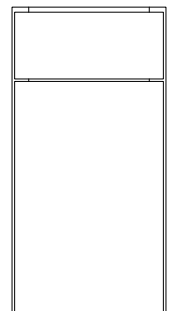

## FRAMELESS FLUSH OVERLAY

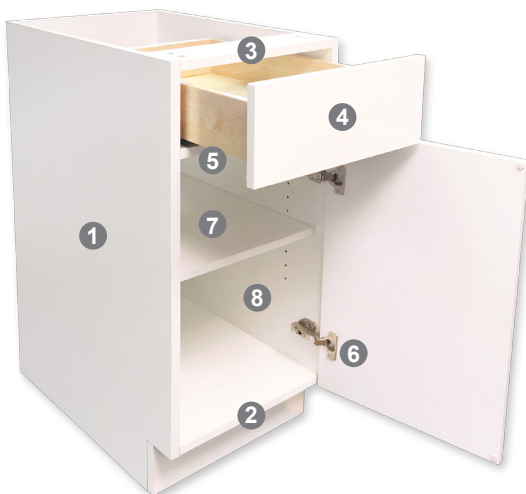

### CONSTRUCTION METHOD: Dowel Pin

1. 3/4" melamine laminate end panels white or finished to match
2. 3/4" PVC edgebanding
3. 3/4" front rail / stretcher
4. 5/8" solid wood dovetailed drawer box  
+ Option: Metal drawer box
5. Soft close full extension undermount 100 lb. glides
6. Soft close adjustable Euro-Style hinges
7. 3/4" melamine laminate full depth adjustable shelving  
+ Option: 3/4" melamine laminate half depth shelving
8. Interior white or finished to match cabinet sides

### Certifications



No Reveal

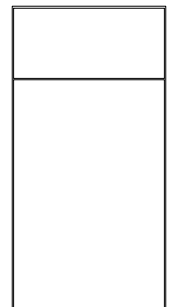

+ MIX & MATCH CONSTRUCTION OPTIONS FOR LARGE QUANTITY ORDERS

# STYLE & FINISH OPTIONS

A quality cabinet is judged by two distinct characteristics – beauty and strength. We have strategically identified the most popular construction options, door styles and finishes and then designed our product lineup around those. You'll find that Choice Cabinet offers traditional and contemporary styles in an ample variety of finishes and colors.

## DOOR STYLES



Slab



Shaker



Recessed Center Panel



Raised Center Panel

## PAINTS & STAINS

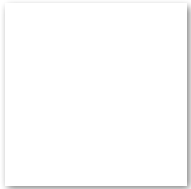

White Paint



Renaissance Paint

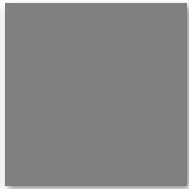

Grey Paint



Sonoma Stain



Tuscan Stain



Dakota Stain

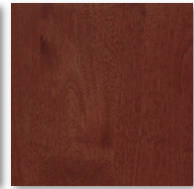

Barrington Stain



Java Stain

## THERMALLY FUSED LAMINATES (TFL)



Grey Ice

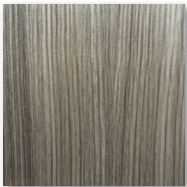

Weathered Elmwood



Ebony Grey



Candlelight

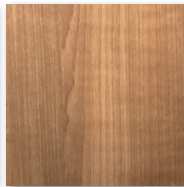

Tuscan Elmwood

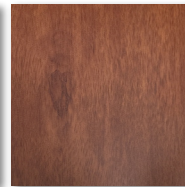

Spiced Fruitwood

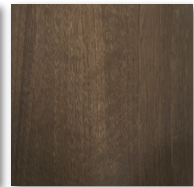

Amber Elmwood



Black Elmwood

## ACRYLICS & LAMINATES

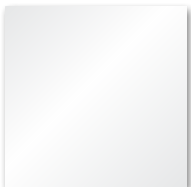

Gloss White Acrylic



Gloss Beige Acrylic



Gloss Ebony Acrylic

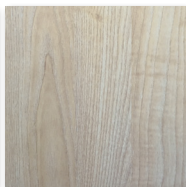

Birch Laminate

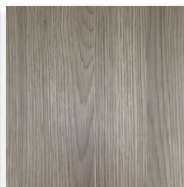

Rustic Oak Laminate

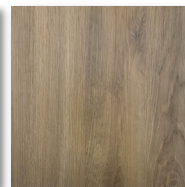

Beechwood Laminate

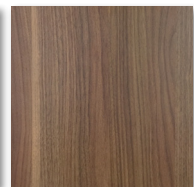

Rosewood Laminate

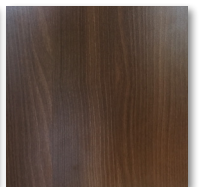

Walnut Laminate

**+ ADDITIONAL DOOR STYLES & FINISHES AVAILABLE**



# SKU OPTIONS

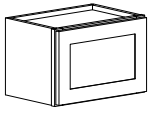

Single Door Wall Bridges

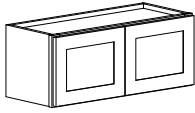

Double Door Wall Bridges

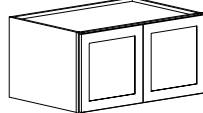

Double Door Deep Wall Bridges

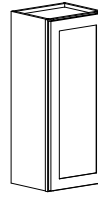

Single Door Walls

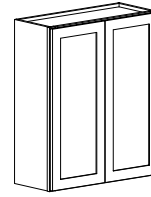

Double Door Walls

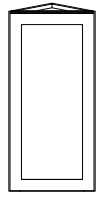

Angled Triangle Walls

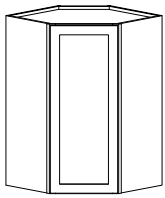

Diagonal Corner Walls

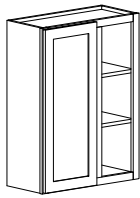

Blind Corner Walls

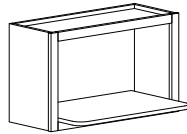

Microwave Shelf Walls

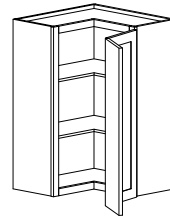

Easy Reach Walls

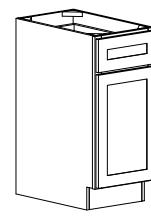

Single Door Bases

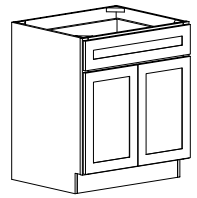

Double Door Bases

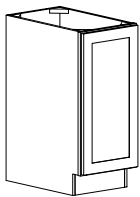

Full Height Door Bases

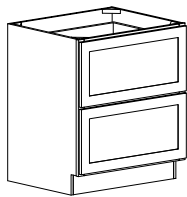

Two Drawer Bases

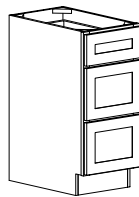

Three Drawer Bases

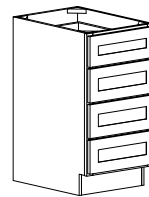

Four Drawer Bases

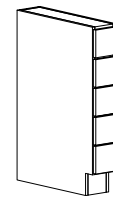

Five Drawer Bases

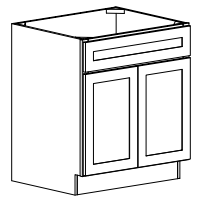

Sink Bases & Vanity Sink Bases

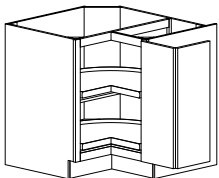

Lazy Susans

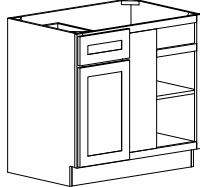

Blind Corner Bases

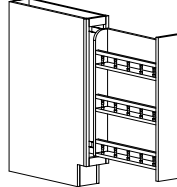

Pull Out Pantry Bases

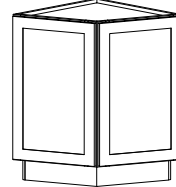

Angled Triangle Bases



Linen Cabinets

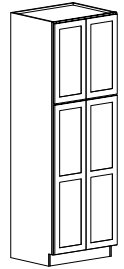

Pantries

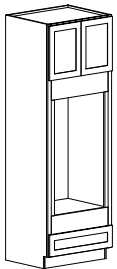

Oven & Appliance Cabinets

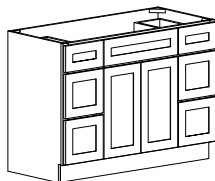

Vanity Combos

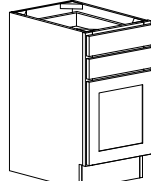

Desk Bases

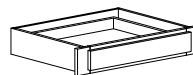

Knee & Pencil Drawers

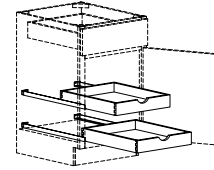

Roll Out Trays

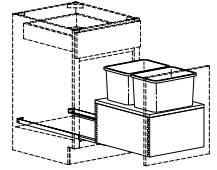

Trash Pull Outs

**+ CUSTOM SIZES & SKUS AVAILABLE FOR LARGE QUANTITY ORDERS**

# OUR PROJECTS

No matter the size of your property, we offer the right product at the right price without the wait. Choice Cabinet is the go-to cabinet brand for property managers, general contractors, architects, and developers. Whether your cabinetry needs are on the turn, by phase, or require a drop ship, we'll have the solution you're looking for.



**300 SWIFT**  
202 Units



**WALNUT ON HIGHLAND**  
118 Units



**FLATS EAST BANK**  
240 Units



**CANAL SQUARE**  
55 Units



# OUR PROJECTS



**THE BRIX AT 26**  
89 Units



**THE CRESWELL**  
80 Units



**HISTORIC ONESTO LOFTS**  
43 Units



**BERKSHIRE NINTH STREET**  
86 Units

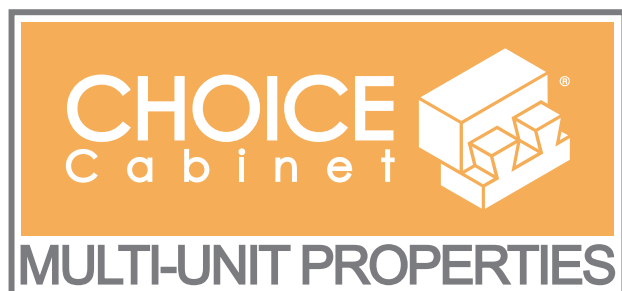

[choicecabinet.com](http://choicecabinet.com)

Your Choice Cabinet Dealer:



In maintaining our policy of continuous product improvement, Choice Cabinet reserves the right to change design and material specifications as required and without notice.

CC018 [Rev 6.1.2016]  
© 2016 Choice Cabinet  
All rights reserved.